

Assembly Instructions for Plate Mount

Attach the gooseneck arm to the plate mount using one 3/8" flat-head screw.
Insert lock washer and washer as shown. Use allen wrench to tighten.

NOTE: 7/32" and 2mm Allen wrenches are included for assembly/disassembly. Keep these in a safe place.

TOOLS REQUIRED: 2 mm and 7/32" Allen wrench (included)

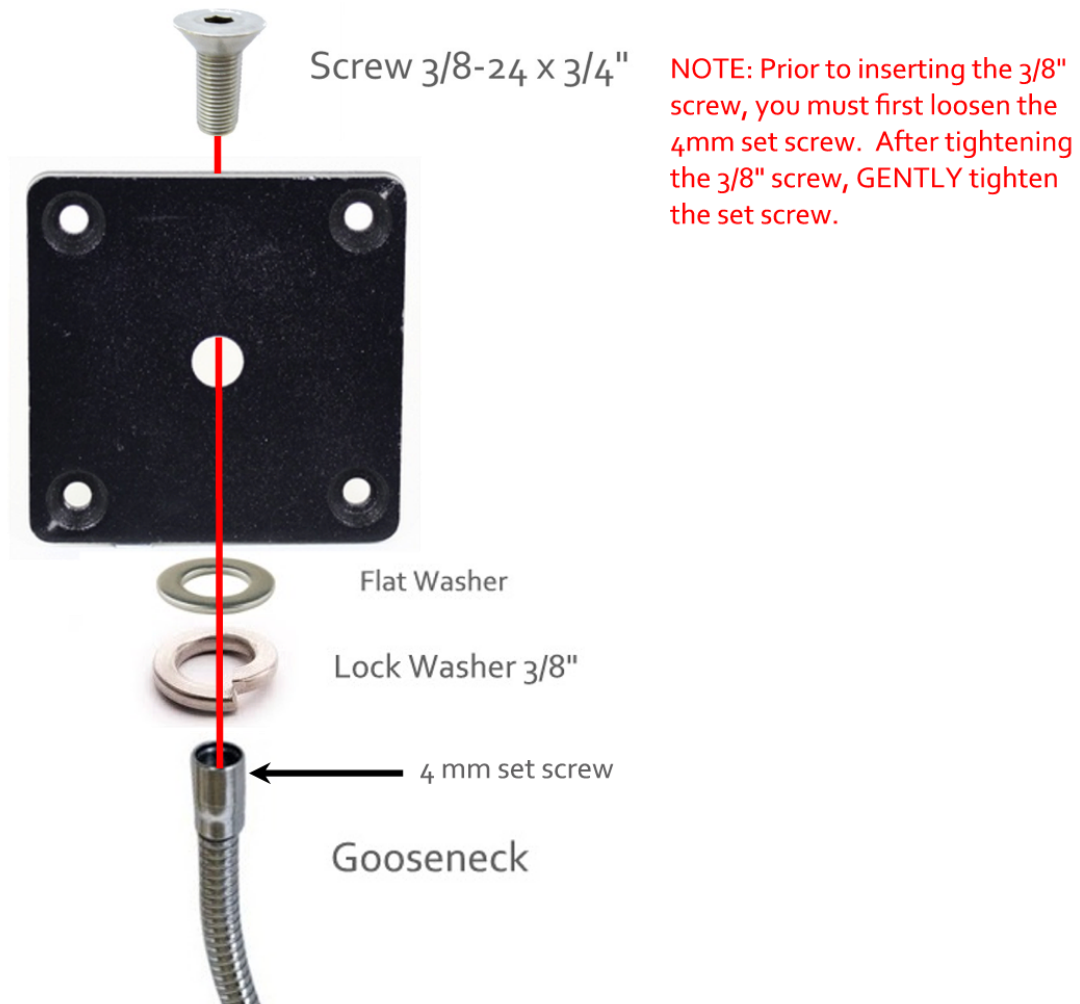

SnakeClamp Products LLC

www.SnakeClamp.com support@snakeclamp.com

